

NOTES:

1. THERMOSTAT CABLE- 4, 8 OR 12 CONDUCTOR- 18 AWG SOLID COPPER WIRE INSULATED WITH HIGH DENSITY POLYETHYLENE. CONDUCTORS PARALLEL. ENCLOSED IN BROWN PVC JACKET. (NO 22 AWG CABLE ALLOWED).
2. IF COMPRESSOR UNITS HAVE THEIR OWN POWER SUPPLY IT MAY BE NECESSARY TO ADD ADDITIONAL RELAYS IN COMPRESSOR UNIT TO PROPERLY INTERFACE CONTROLS.
3. USE WIRE NUT CONNECTORS FOR SPlicing CONDUCTORS IN SPECIFIED LOCATIONS. AND TYTON TYPE CRIMP CONNECTORS FOR TERMINAL CONNECTIONS. NO TERMINAL CONNECTORS REQUIRED AT THERMOSTAT OR SENSOR.
4. DO NOT RUN ANY OTHER WIRING IN THIS CONDUIT EXCEPT THERMOSTAT CABLE.
5. VERIFY THAT FAN UNIT FAN SPEED CONTROL WIRING IS SET TO MATCH SCHEDULE SHEET AND THAT FAN OPERATES AT COOLING SPEED ONLY.
6. DO NOT SPlice WIRE IN RUNS FROM SENSOR TO THERMOSTAT, THERMOSTAT TO FURNACE, AND THERMOSTAT TO DISCHARGE AIR SENSOR.
7. PROVIDE CHASE NIPPLE WITH PLASTIC BUSHING WHEN ATTACHING J-BOX TO EQUIPMENT.
8. PROVIDE CABLE-CLAMP SO THAT CABLES CANNOT BE PULLED OUT OF J-BOX.

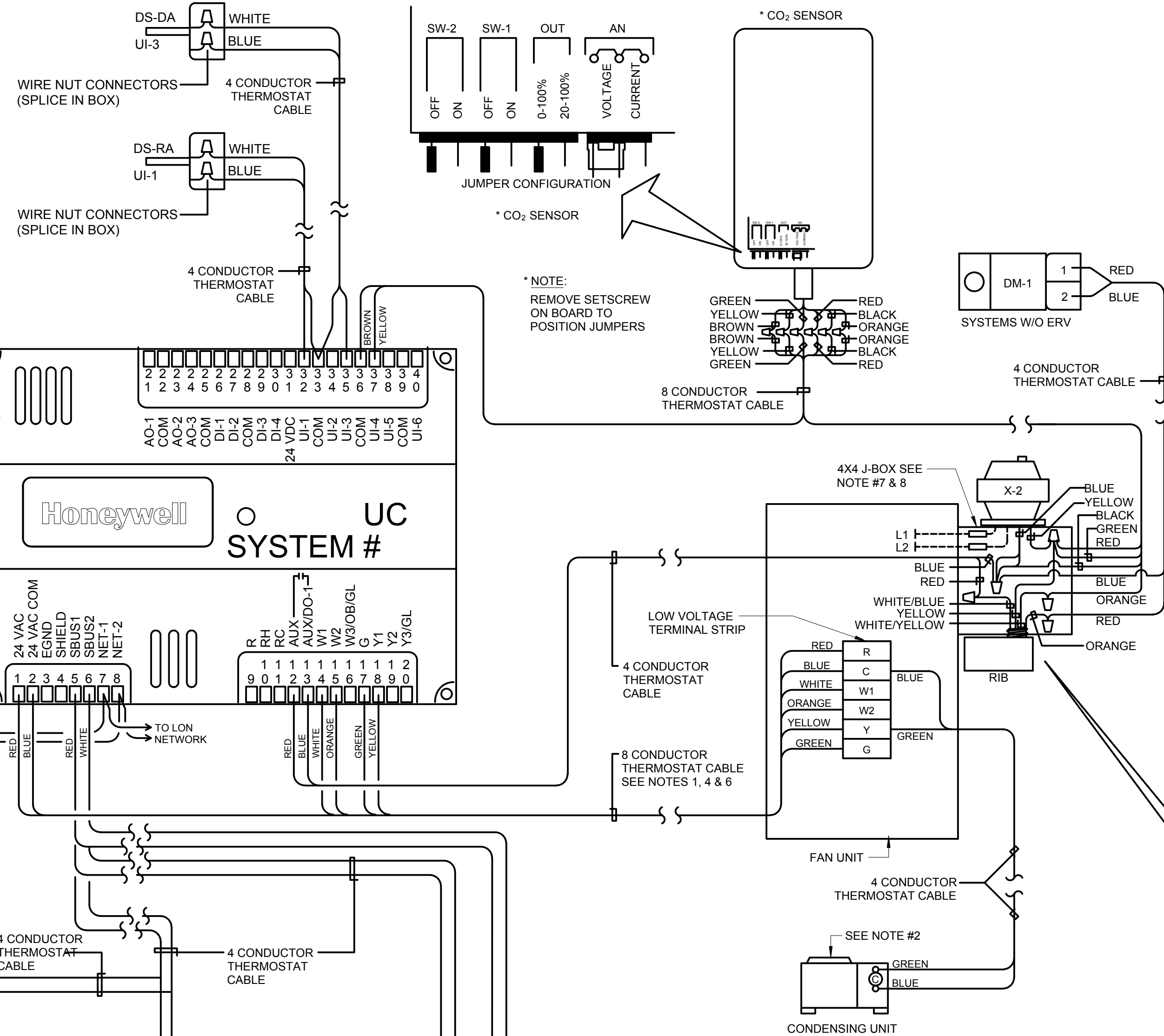

- NOTES:**
1. ECHELON BUS (E-BUS) MUST BE INSTALLED AT LEAST 12" AWAY FROM ALL ELECTRICAL DEVICES: I.E. MOTORS, LIGHT, ETC.
 2. DO NOT USE THERMOSTAT CABLE AS NETWORK CABLE. USE SPECIFIED CABLE.

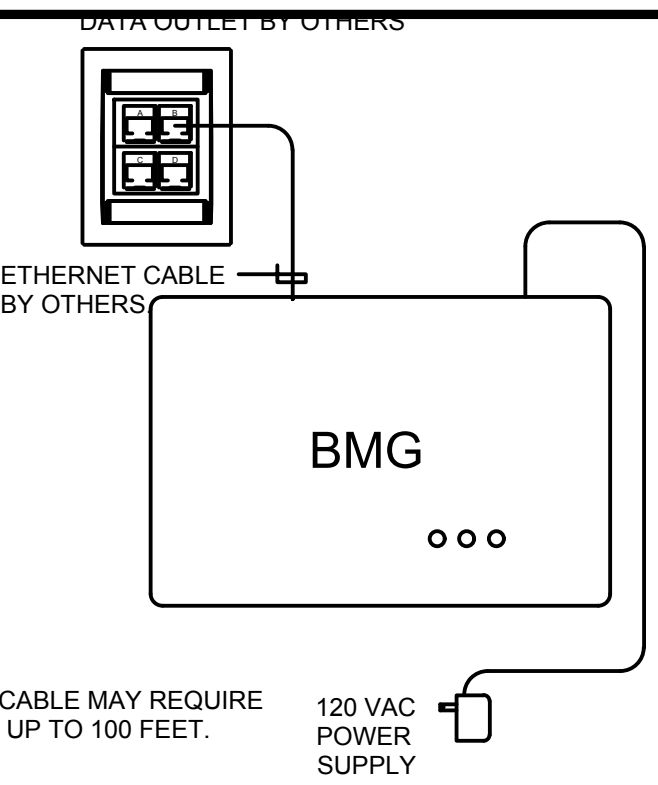
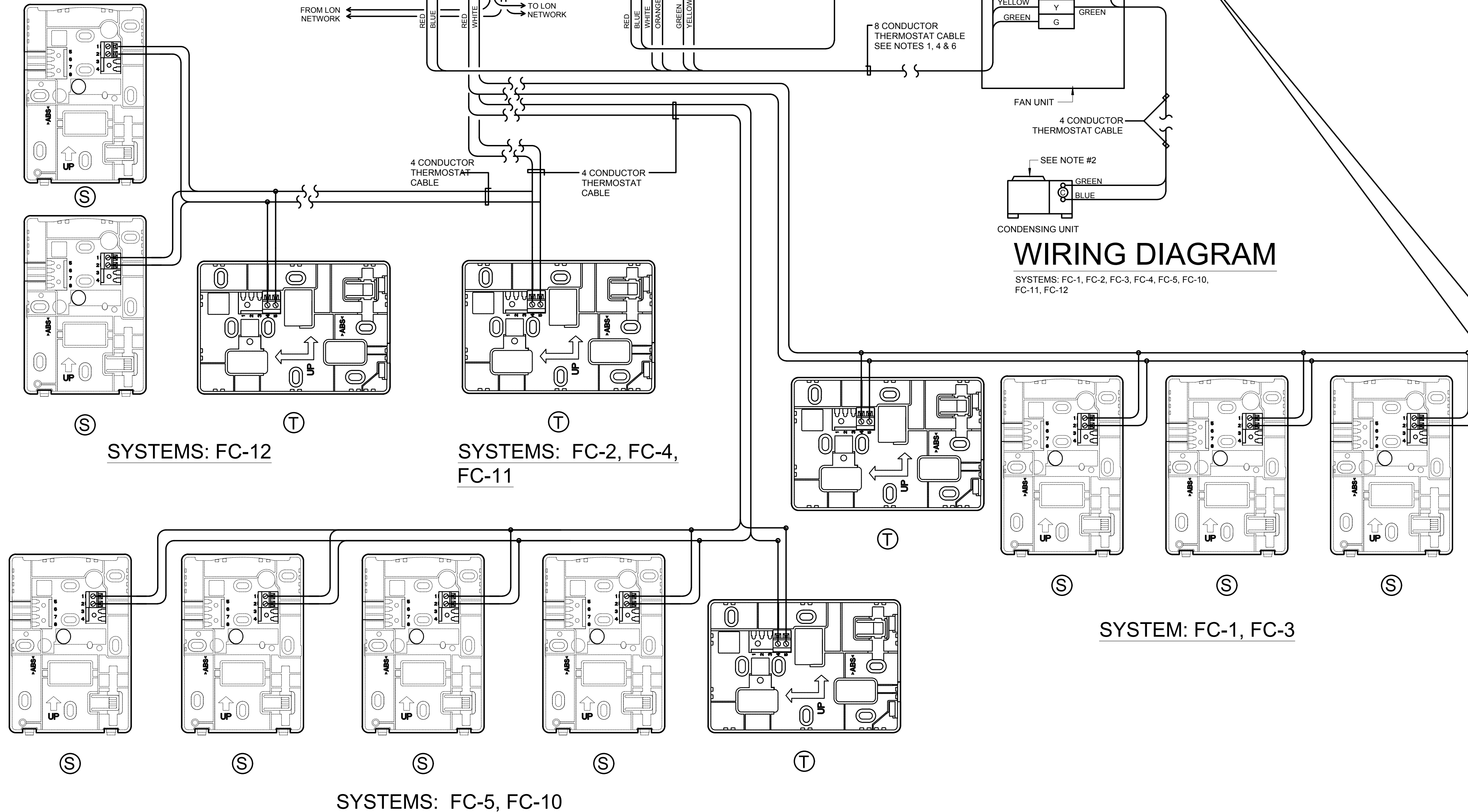

- NOTES:**
1. ETHERNET CABLE MAY REQUIRE LENGTH OF UP TO 100 FEET.

- LEGEND:**
- DIVISION 26 OR FACTORY PRE-WIRED
 - _____ DIVISION 23 WIRING

BMG WIRING DIAGRAM

| CONTROL EQUIPMENT | | | | | |
|-------------------|---------------------------------|--|-------|---|----------------|
| MARK | DESCRIPTION | CAT. NO. (1) | MARK | DESCRIPTION | CAT. NO. (1) |
| BMG | BUILDING MANAGEMENT GATEWAY | LGW1000 (GATEWAY) WPM-8000 (WALL PLUG) | RP-6 | RELAY PANEL 24X18X6W/COVER | (2) (4) |
| UC | UNITARY CONTROLLER | YCRL64385R1000 | DM-1 | DAMPER MOTOR TWO POSITION | MS8105A1030 |
| T | THERMOSTAT WALL MODULE | LCBS WALL MODULE | DM-2 | DAMPER MOTOR 2 POS W/END SWITCH | MS8105A1130 |
| | THERMOSTAT COVER PLATE ASSEMBLY | 50002883-001 | X-1 | TRANSFORMER 120, 208, 240V/24V 75VA | AT175F1023 |
| S | REMOTE SENSOR | TR40 | X-2 | TRANSFORMER 120V/24V 50VA | AT150F1022 |
| G-1 | THERMOSTAT GUARD | (2) | SD-1 | DUCT SMOKE DETECTOR | (2) |
| DS | DUCT AIR SENSOR | C7041B2005 | SR | SMOKE RELAY 30 AMP 120V COIL | DP2030B5003 |
| CO ₂ | CO ₂ SENSOR | C7232B1006 | RIB | TWO POLE RELAY | RIBU1C (2) |
| | | | RIB | TWO POLE RELAY 20 AMP | RIB2401B (6) |
| | | | OAS | GLOBAL OUTDOOR AIR SENSOR | C7041F2006 (7) |
| | | | CRO | COMBINATION RELAY & THERMAL OVERLOAD DISCONNECT | (2) (4) |
| | | | E-BUS | ECHELON NETWORK CABLE | W221P-2001B |

- (1) ALL CATALOG NUMBERS SHOWN ARE HONEYWELL UNLESS NOTED OTHERWISE.
- (2) SEE SPECIFICATIONS
- (3) PROVIDE ENCLOSURE
- (4) TO BE PURCHASED FROM AN APPROVED PER-BUILT PANEL BUILDER SEE SPECIFICATION.
- (5) SEE PLAN FOR REQUIRED SIZE AND ZONE NUMBER.
- (6) USE WITH CRO DISCONNECT FOR ELECTRIC WALL HEATER. CONTROL FROM UC.
- (7) ONLY ONE REQUIRED FOR BUILDING. MAY BE CONNECTED TO ANY CONTROLLER AT NORTH SIDE.

WIRING DIAGRAM
SYSTEMS: FC-1, FC-2, FC-3, FC-4, FC-5, FC-10, FC-11, FC-12

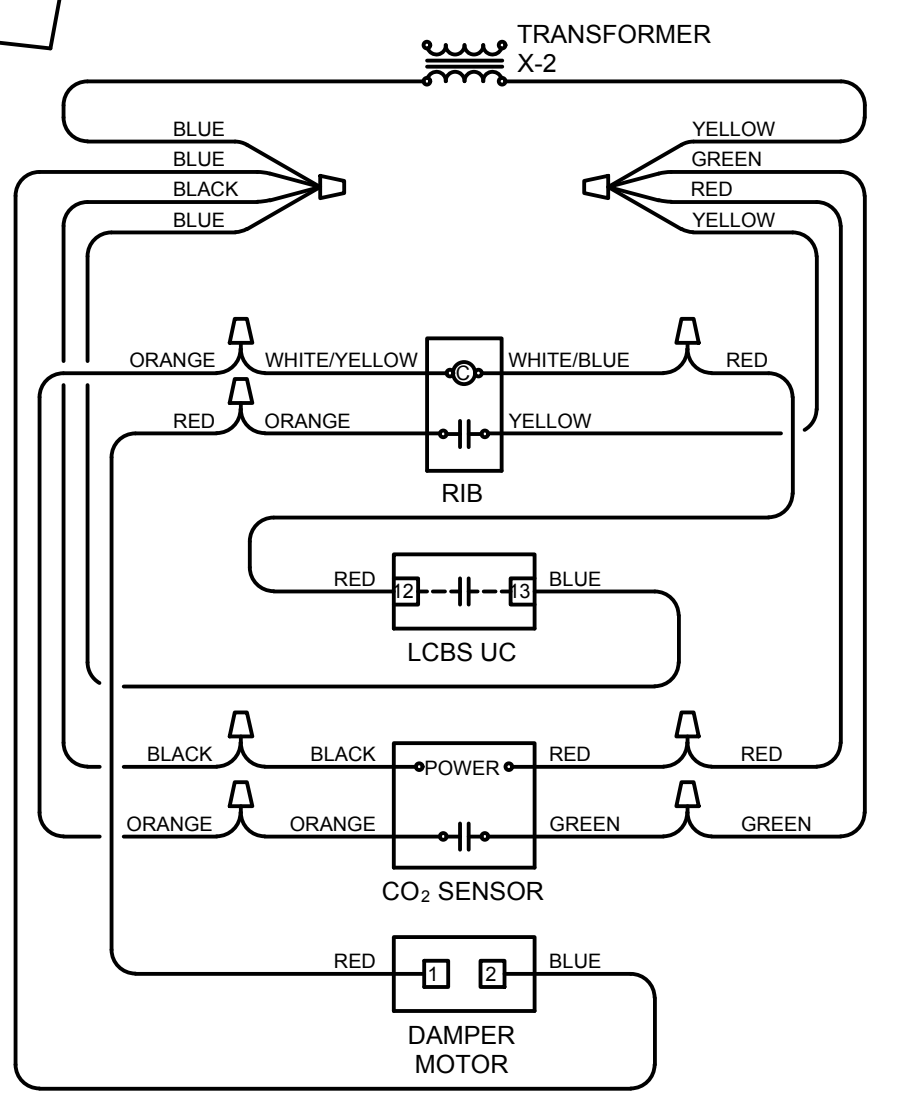

WIRING SCHEMATIC, X-2



Engineered Systems Associates
Mechanical Engineers

Dwayne Sudweeks
1355 East Center - Pocatello, Idaho 83201
Phone: (208) 233-0501 Fax: (208) 233-0529 email: esa@engsystems.com

HVAC UPGRADE FOR: PROPERTY # 521-1514
ZONE 5 | SEC 5 | PLAT 004 | PARCEL 15

LDS LAIE 1,8,9

55-1109 LANIHULI ST

LAIE, HAWAII

CONTROLS

PROJECT:

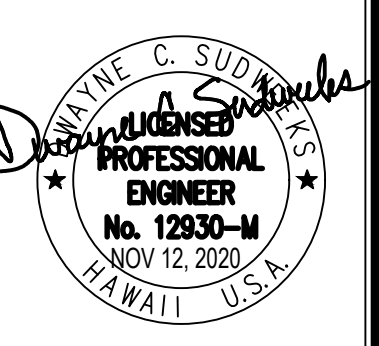

| | |
|----------------------|------------------------|
| DRWN. BY: T DAVIS | CKD. BY: D.SUDWECKS |
| JOB NO. 20040 | DATE: NOV 2020 |

SHEET:
ME4.0
OF: 13